

37

W. line SE $\frac{1}{4}$  SEC 3-78-4  
ROAD  
GLEN  
DEVILS

51

55

Alvin W. Harlez & KF  
1-25-58

500'  
W. 4-92  
05333-92  
Pleasant Valley Comm. School  
District  
3-5-90  
03554-90

3  
10

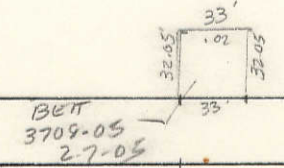

HOPEWELL

AVENUE

Section line between SECS 3 & 10

2 S $\frac{1}{4}$  Corner SEC 3-78-4

SEC 10

5

VOL G